

INGRESS

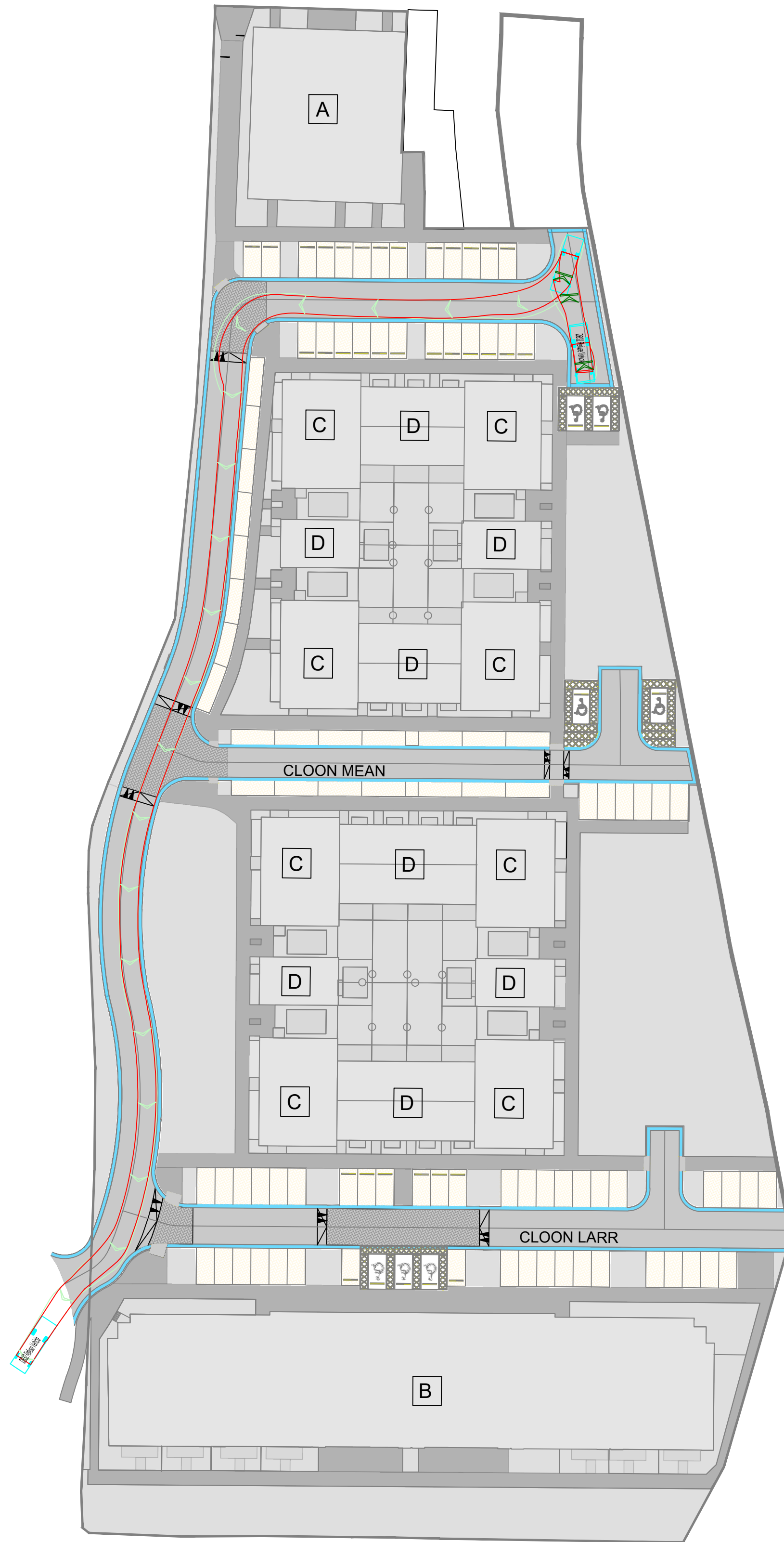
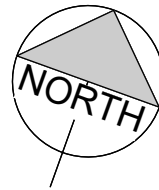

EGRESS

DO NOT SCALE FROM THIS DRAWING. USE FIGURED DIMENSIONS IN ALL CASES.
VERIFY DIMENSIONS ON SITE AND REPORT ANY DISCREPANCIES TO THE DESIGNERS IMMEDIATELY.
THIS DRAWING TO BE READ IN CONJUNCTION WITH THE DESIGNERS SPECIFICATION.
© THIS DRAWING IS COPYRIGHT AND MAY ONLY BE REPRODUCED WITH THE DESIGNERS PERMISSION.

SWEPT PATH ANALYSIS (SPA) LEGEND

- EXTENT OF BODY OUTLINE
- EXTENT OF WHEELBASE FOOTPRINT
- EXTENT OF LOAD OUTLINE
- EXTENT OF VEHICLE OUTLINE
- EXISTING ROAD
- PROPOSED ROAD
- CONCRETE APRON

VEHICLE DETAILS:

Green line shows body
Orange line shows axle/wheels

DB32 Refuse Vehicle
Overall Length 7.900m
Overall Width 2.400m
Overall Body Height 3.183m
Min Body Ground Clearance 0.388m
Max Track Width 2.400m
Lock-to-lock time 6.00s
Curb to Curb Turning Radius 9.625m
Design speed 5kph for all Forward movements
Design speed 2.5kph for all Reverse movements

28.08.23		ISSUED FOR INFORMATION		JH	IB
REV	DATE	DESCRIPTION		BY	APP
PROJECT:					
CLOONMORE DEVELOPMENT, TRALEE					
TITLE:					
AUTO TRACKING - REFUSE VEHICLE SHEET 3 OF 3					
CLIENT:					
TULFARRIS CG LTD					
<div><div>MWP</div><div>ENGINEERING AND ENVIRONMENTAL CONSULTANTS</div><div>CORK TRALEE LONDON LIMERICK</div><div>mwp.ie</div></div>					
DRAWN: J.H.		CHECKED: G.F.		APPROVED: I.B.	
PROJECT NUMBER: 23824		DATE: AUG.2023		SCALE @ A1: 1:500	
STATUS DESCRIPTION FOR INFORMATION				STATUS: S2	
DRAWING NUMBER: 23824 - MWP - 00 - 00 - DR - C - 0405				REV: P01	