

INGRESS

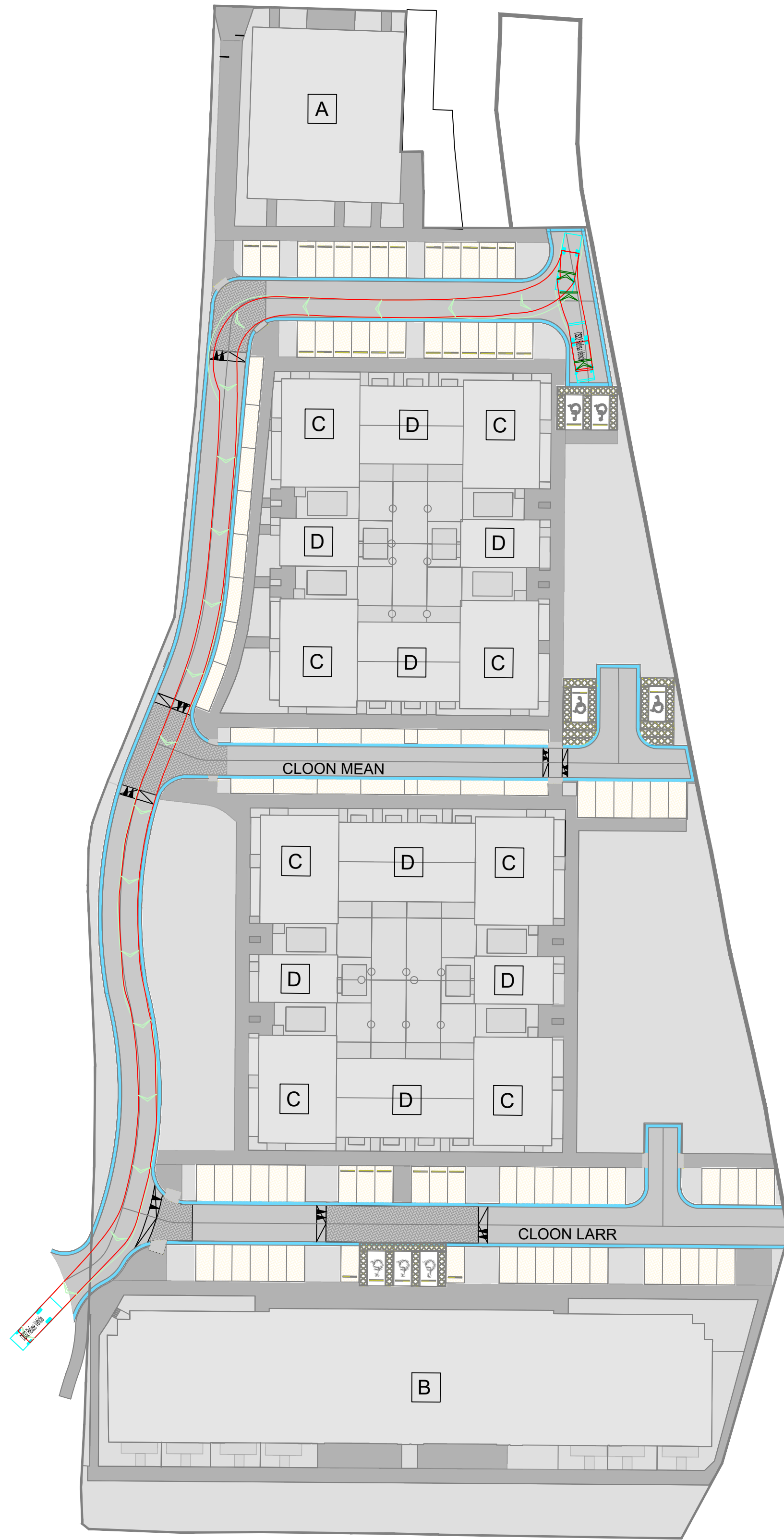
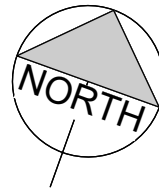

EGRESS

DO NOT SCALE FROM THIS DRAWING. USE FIGURED DIMENSIONS IN ALL CASES.  
VERIFY DIMENSIONS ON SITE AND REPORT ANY DISCREPANCIES TO THE DESIGNERS IMMEDIATELY.  
THIS DRAWING TO BE READ IN CONJUNCTION WITH THE DESIGNERS SPECIFICATION.  
© THIS DRAWING IS COPYRIGHT AND MAY ONLY BE REPRODUCED WITH THE DESIGNERS PERMISSION.

SWEPT PATH ANALYSIS (SPA) LEGEND

- EXTENT OF BODY OUTLINE
- EXTENT OF WHEELBASE FOOTPRINT
- EXTENT OF LOAD OUTLINE
- EXTENT OF VEHICLE OUTLINE
- EXISTING ROAD
- PROPOSED ROAD
- CONCRETE APRON

VEHICLE DETAILS:

DB32 Fire Appliance

Overall Length	8.680m
Overall Width	2.180m
Overall Body Height	3.452m
Min Body Ground Clearance	0.337m
Max Track Width	2.121m
Lock-to-lock time	6.00s
Curb to Curb Turning Radius	7.910m
Design speed 5kph for all Forward movements	
Design speed 2.5kph for all Reverse movements	

Green line shows body  
Orange line shows axle/wheels

28.08.23		ISSUED FOR INFORMATION		JH	IB
REV	DATE	DESCRIPTION		BY	APP
PROJECT:					
CLOONMORE REGENERATION LRD,TRALEE					
TITLE:					
AUTO TRACKING - FIRE APPLIANCE SHEET 3 OF 3					
CLIENT:					
TULFARRIS CG LTD					
<div><div>MWP</div><div>ENGINEERING AND ENVIRONMENTAL CONSULTANTS</div><div>CORK   TRALEE   LONDON   LIMERICK</div><div>mwp.ie</div></div>					
DRAWN:		CHECKED:		APPROVED:	
J.H.		G.F.		I.B.	
PROJECT NUMBER:		DATE:		SCALE @ A1:	
23824		AUG.2023		1:500	
STATUS DESCRIPTION				STATUS:	
FOR INFORMATION				S2	
DRAWING NUMBER:				REV:	
23824 - MWP - 00 - 00 - DR - C - 0402				P01	